



### FEATURES

- 14" IPS LCD Screen (1920 x 1080 Resolution)
- Intel Kaby Lake i5-7Y54 Dual-core Processor
- Windows 10 Pro
- IP-54 Water & Dust Protection
- 3ft Drop/Shock Protection (MIL-STD-810G)
- Long Life Battery – up to 20 Hours Runtime
- 10-Point Capacitive Touchscreen
- Options: Smart Card Reader, GPS & NFC

The MT-140 Semi-Rugged Tablet is a 14" Intel-powered tablet for medical and commercial uses. The medical-grade chassis and IP54 waterproof front screen can be easily disinfected. The VESA mounting allows for use with wheelchairs, computer carts, and more. A large, high definition screen and a variety of options make this the perfect choice for any semi-permanent application.

### SPECIFICATIONS

#### RUGGEDNESS

Waterproof	IP-54 Rated Front Panel
Drop Rating	MIL-STD-810G, 3ft to Plywood on 4 Corners
Shock Rating	MIL-STD-810G, Method 516.6, Procedure I
Vibration Rating	MIL-STD-810G, Method 514.6, Procedure I, Category 4, Category 20, Category 24
ESD Protection	8KV Touch, 15KV Air

#### SYSTEM

Processor	Intel Kaby Lake i5-7Y54 Dual-core, Base 1.20 GHz, Burst 3.20 GHz
GPU	Intel HD Graphics 615, Base 300MHz, Burst 950MHz, Max Video Memory 16GB
Memory	8GB LPDDR3-1866 <b>Options:</b> 16GB LPDDR3-1866
OS	Windows 10 Pro, LTSB
Storage	256GB SSD M.2 Interface <b>Options:</b> 512GB SSD M.2 Interface 1TB SSD M.2 Interface
Security	Intel AES New Instructions <b>Options:</b> TPM 2.0

#### DISPLAY

Screen Size	14" IPS
Resolution	1920 x 1080
Brightness	300 NIT
View Angle	+/- 85°
Contrast Ratio	800:1
Touch Screen	Capacitive 10-Point Multi-Touch <b>Glass Coating Options:</b> Anti-Reflective Anti-Glare Anti-Fingerprint

#### COMMUNICATIONS

Wi-Fi	802.11 a/b/g/n/ac Dual-Band 2.4G & 5G
Bluetooth	Bluetooth v4.2
GPS (Option)	GPS/QZSS L1 C/A, GLONASS L1 FDMA, SBAS: WAAS, EGNOS, MSAS Navigation Update Rate Up to 10Hz, Cold Start No More Than 40s Cold Start No More Than 40s
NFC (Option)	Compliant with ISO/IEC 14443 A/B, 15693/18092, Distance 2.5mm

#### I/O INTERFACE

Sensors	Gyroscope Light Sensor Compass
Audio	1x Built-In Microphone 1x Internal 8ohm 1W speaker
Camera	Front Camera: 2MP Rear Camera: 5MP with Auto Focus
Ports	2x USB 3.0 @ 1.5A Type A 1x HDMI Output Type A 1x Audio Jack (3.5mm, 4 Pole, MIC input) 1x DC Jack 2.5mm OD Jack <b>Options:</b> 1x RJ45 10/100M Port
Buttons	Power Button Volume +, Volume - Reset
Smart Card Reader (Option)	Smart Card Reader, ISO 7816 Type A/B/C Card EN60950/IEC 60950, ISO 7816 Certification, EMV Level 1

#### MECHANICAL

Chassis	Front: Magnesium Alloy, Rear: Plastic <b>Options:</b> Anti-Microbial
VESA Mount	100 x 100mm
Dimensions	358 x 226 x 36mm
Weight	2.4kg

#### POWER

AC Adaptor	AC adaptor 110 -240V AC Input , 12V 3A Output, Standard US Plug <b>Options:</b> Medical AC Adaptor 110 -240V AC Input , 12V 3.3A Output
Battery	1x 74Wh Battery, Li-on Polymer, 2S2P, 7.4V 10000mAh 10+ Hours Runtime (Per Battery) <b>Options:</b> Additional 74Wh Battery

#### ENVIRONMENTAL

Operating Temp	0°C to 40°C
Storage Temp	-20°C to 60°C
Humidity	10% to 90%
RoHS	Compliant

#### REGULATORY

Certification	FCC, IATA, IEC461F
---------------	--------------------

\*Specifications are representative. Specific product technology may be different than indicated.

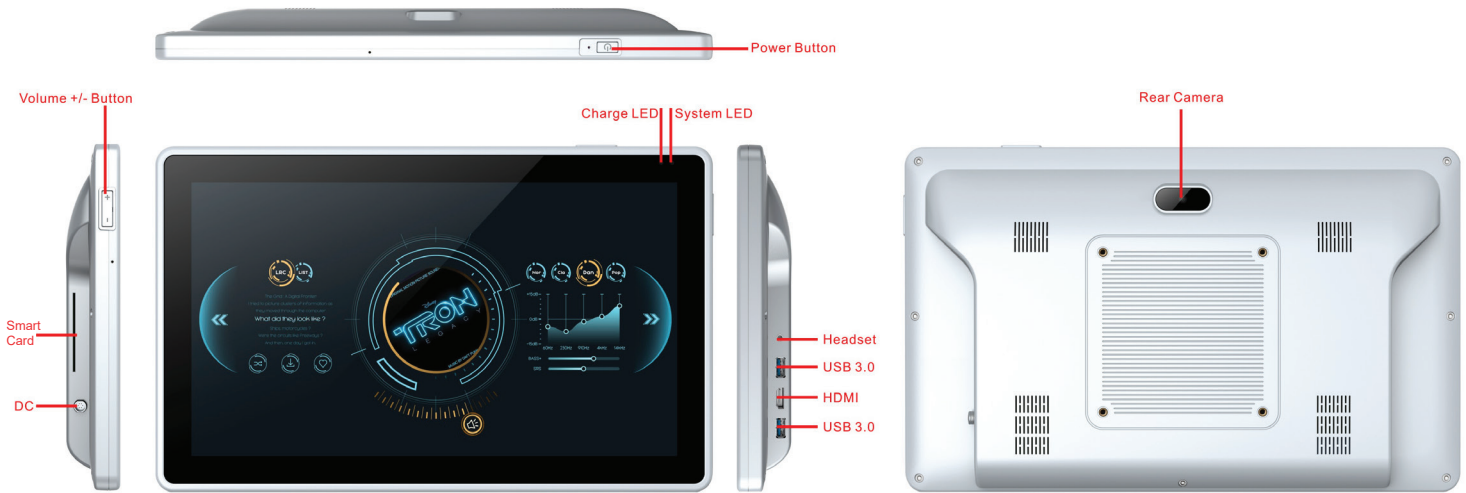

### ODM OPTIONS

#### SYSTEM

Memory 16GB LPDDR3-1866  
Storage 512GB SSD M.2 Interface (2280)  
1TB SSD M.2 Interface (2280)

#### DISPLAY

Glass Coating Options Anti-Reflective  
Anti-Glare  
Anti-Fingerprint

#### COMMUNICATIONS

GPS GPS/QZSS L1 C/A, GLONASS L1 FDMA, SBAS: WAAS, EGNOS, MSAS  
Navigation Update Rate Up to 10Hz, Cold Start No More Than 40s  
Cold Start No More Than 40s  
NFC Compliant with ISO/IEC 14443 A/B, 15693/18092, Distance 2.5mm

#### I/O INTERFACE

Port 1x RJ45 10/100M Port  
Smart Card Reader Smart Card Reader, ISO 7816 Type A/B/C Card  
EN60950/IEC 60950, ISO 7816 certification, EMV Level 1

#### MECHANICAL

Chassis Anti-Microbial

#### POWER

AC Adapter Medical AC Adaptor 110 -240V AC Input , 12V 3.3A Output  
Battery Additional 74Wh Battery

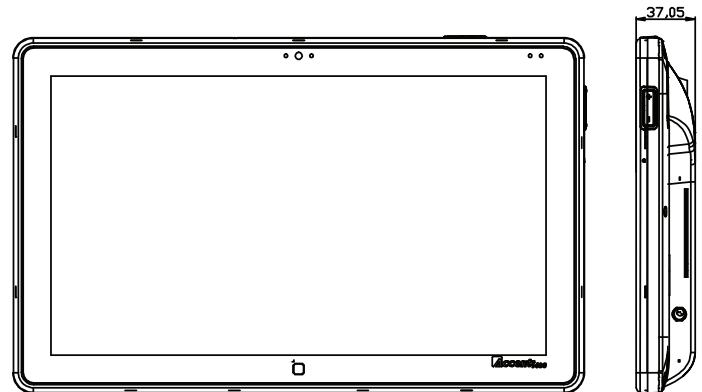
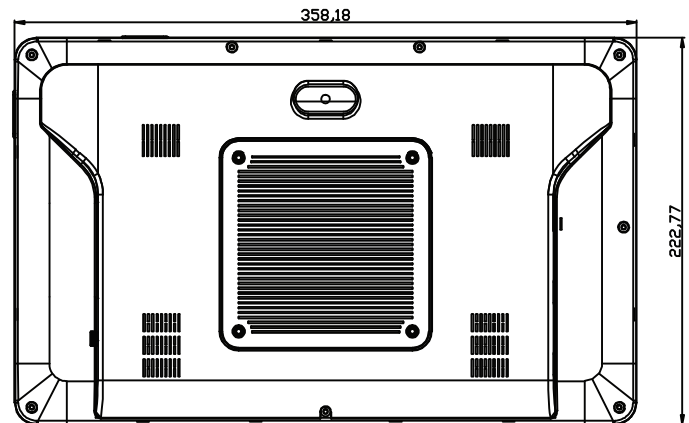

### ACCESSORIES



Docking Station