

FEATURES



- 7" Touchscreen LCD with 1024 x 600 Resolution  
(Optional: 10" or 15" LCD)
- Available as a Standalone Panel or with an Open-Frame Structure
- High-Performance Quad-Core ARM Processor
- Supports Android 14 or Linux Operating Systems
- Versatile I/O Options: USB, RS232/485, and LAN Connectivity
- Advanced RF Options: Wi-Fi, Bluetooth, ZigBee, and RFID
- IP67 Water & Dust Protection
- Wide Temperature Range: 0°C to 50°C (Optional: -20°C to 60°C)
- Seamless Integration with Estone IoT MDM Software

The HMI-70 is a robust and versatile Human-Machine Interface powered by a Quad-core Cortex-A55 processor running Android 14 or Linux. Designed for demanding applications, it features a 7-inch capacitive multi-touch IPS display with 1024 x 600 resolution, supporting wet and glove touch modes. The display offers an optional upgrade to 10-inch or 15-inch sizes for flexible deployment needs. This IP67-rated panel is built to endure harsh environments with wide operating temperatures and resistance to water and dust. With advanced connectivity options, including dual-band Wi-Fi, Bluetooth 5.0, RS232/485, Zigbee, and RFID, it ensures seamless integration into IoT ecosystems. The HMI-70 supports AWS cloud services, providing seamless remote monitoring, OTA updates, and intuitive control through a dedicated mobile app. With optional programmable buttons and an open-frame structure, it offers unmatched adaptability for industrial automation, smart home systems, IoT deployments, and food safety applications. Certified to FCC, CE, and RoHS standards, this device guarantees compliance and reliability for global markets.

SPECIFICATIONS

RUGGEDNESS

IP Rating	IP67 Water & Dust Protection
Wide Temperature	0°C to 50°C (Optional: -20°C to 60°C)

SYSTEM

Processor	Quad-core Cortex-A55, up to 2.0GHz
Memory	4GB LPDDR4
Storage	16GB eMMC Optional: 32GB/64GB/128GB
OS	Android 14 or Linux

DISPLAY

Screen Size	7" IPS LCD (Optional: 10" or 15")
Resolution	1024 x 600
Brightness	400 nits (Typical)
Touch Screen	Capacitive 5-point Touch, Supports Wet & Glove Modes

COMMUNICATIONS

Wi-Fi	802.11 a/b/g/n/ac/ax
Bluetooth	Bluetooth v5.0
RF Options	Zigbee, RFID

POWER

AC/DC Adapter	Input AC 100-240V, 50/60Hz Output DC 12V/3A
---------------	--

I/O & SENSOR

Sensor	Temperature, Ambient Light Sensor
I/O Options	USB 2.0, RS232/485, LAN
DC Input	12V, 3A
Button	Power, Vol +/-

MECHANICAL

Dimensions	191.9 x 129.9 x 14.6mm
Chassis Options	Open Frame Chassis

ENVIRONMENTAL

Temperature:	
- Operation	0°C to 50°C Optional: -20°C to 60°C
- Storage	-20°C to 70°C

REGULATORY

Certifications	FCC, CE, RoHS, IC
----------------	-------------------

## DESIGN OPTIONS



Standalone Panel



Open-Frame Structure

## OPTIONAL ESTONE IoT-LINK SOFTWARE (Intelligent Device Control)

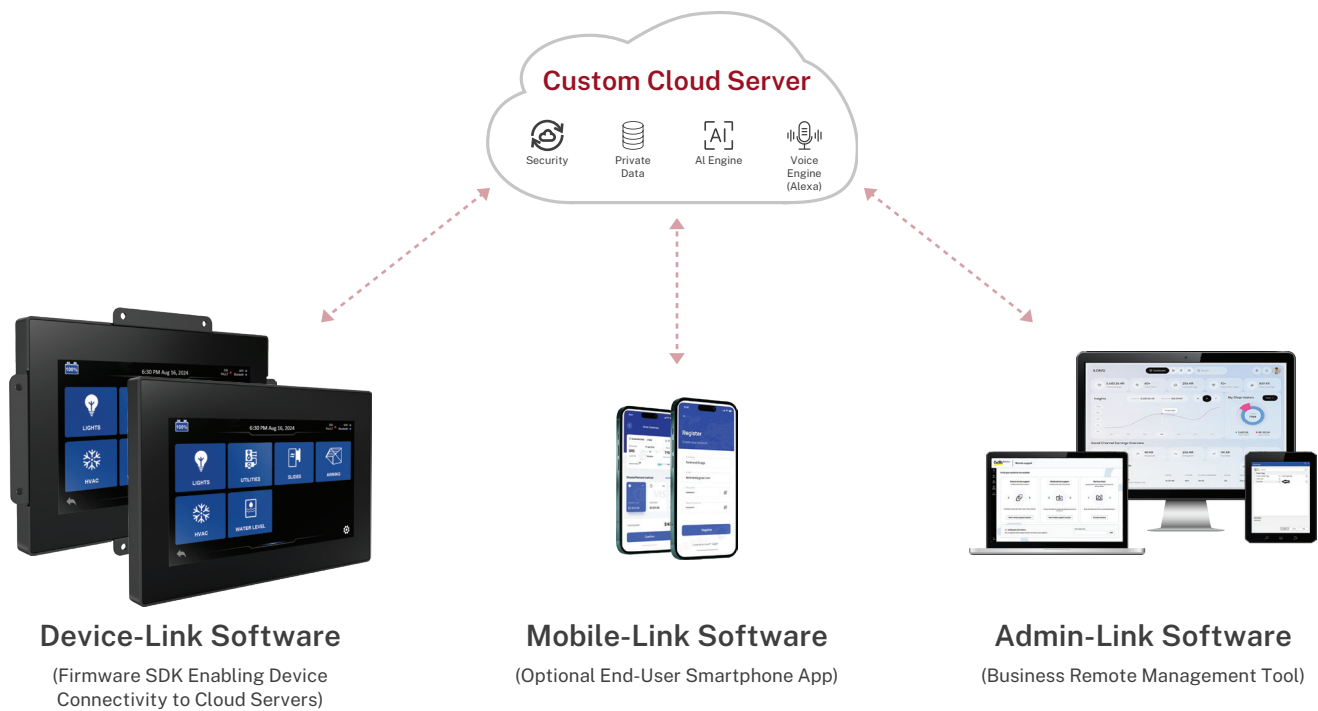

## APPLICATIONS



Home Appliance Control



Industrial Control



Control Panel for RVs, Boats, Golf Carts, etc.